

GENERAL NOTES:

1. ALL SIGNS AND SPACING SHALL CONFORM TO THE MUTCD.
2. NOTIFY LOCAL EMERGENCY SERVICES OF CLOSURE TIMES AND DATES (OPTIONAL).
3. SIGN SPACING MAY BE REDUCED IN URBAN AREAS TO FIT ROAD CONDITIONS.
4. PROTECTIVE VEHICLE RECOMMENDED-MAY BE A WORK TRUCK.
5. ALL SIGNS MINIMUM 48" X 48", UNLESS OTHERWISE SPECIFIED.
6. ALL SPACING MAY BE ADJUSTED TO ACCOMMODATE AT-GRADE INTERSECTIONS AND/OR DRIVEWAYS.

SIGN SPACING = X		
FREEWAYS & EXPRESSWAYS	55-70 MPH	1500'±
RURAL HIGHWAYS	60-65 MPH	800'±
RURAL ROADS	45-55 MPH	500'±
RURAL ROADS & URBAN ARTERIALS	35-40 MPH	350'±
RURAL ROADS & URBAN ARTERIALS	25-30 MPH	200'± (2)
RESIDENTIAL & BUSINESS DISTRICTS		
URBAN STREETS	25 MPH OR LESS	100'± (2)

(1) ALL SPACING MAY BE ADJUSTED TO ACCOMMODATE INTERCHANGE RAMP, AT-GRADE INTERSECTIONS AND DRIVEWAYS.
 (2) THIS SPACING MAY BE REDUCED IN URBAN AREAS TO FIT ROADWAY CONDITIONS.

LEGEND:

- CHANNELIZING DEVICE
- FLAGGING STATION
- PORTABLE SIGN AND SUPPORT
- ☒ WORK VEHICLE WITH FLASHING LIGHT
- ▨ WORK AREA

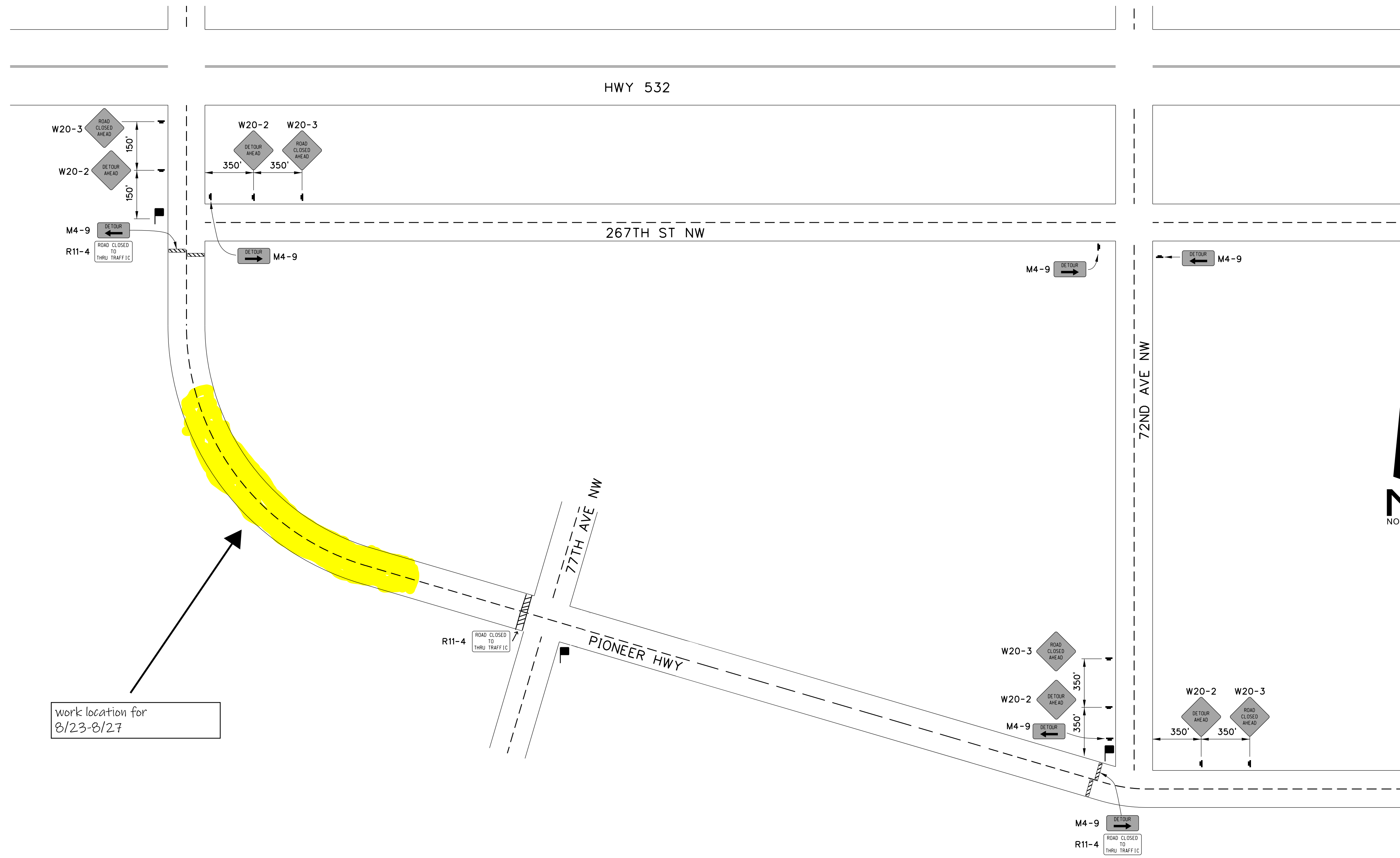

		TRAFFIC CONTROL PLAN	
PROJECT	TWIN CITY SUBSTATION FEEDERS		
LOCATION	BETWEEN 7300 & 27000 BLOCK OF PIONEER HWY		
ENGINEER	JEREMY MUZZY	DATE	8/2/21
PHONE	(425) 783-5669	ORDER	100061694
CELLULAR	(425) 319-4506		

FILE: Y:\WorkGroups\Transmission & Distribution\Muzzy\TWIN CITIES TCP.dgn
 DATE: 02-Aug-21 15:48